

<div>IF IN DOUBT ASK</div> <div>ISO9001:2015 QUALITY ASSURED</div> <div> </div>	ISSUE	DESCRIPTION	T/O No.	DRAWN	DATE	APPROVED	DATE
	A	RELEASE FOR CUSTOMER APPROVAL	tba	E.C	1/8/18	—	—

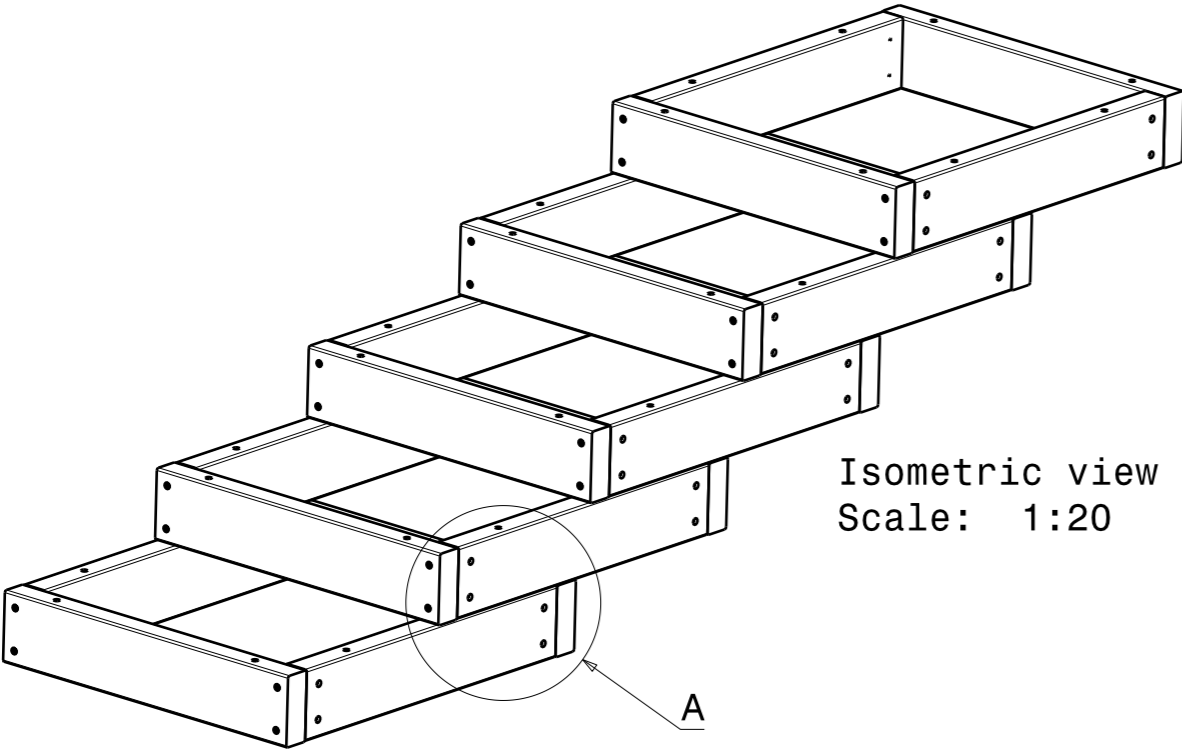

Isometric view
Scale: 1:20

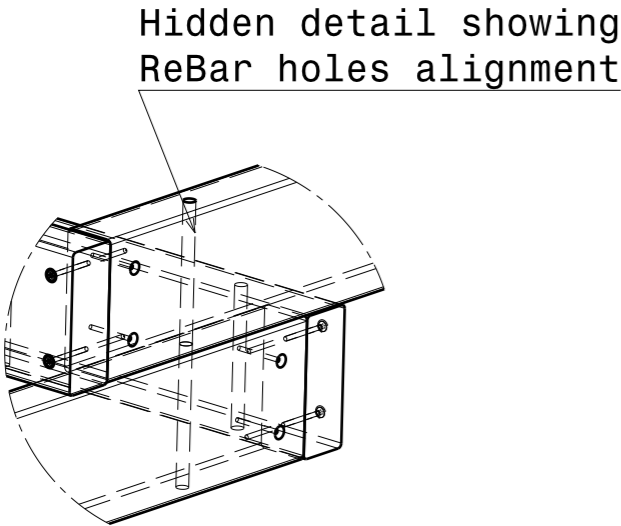

Detail A
Scale: 1:10

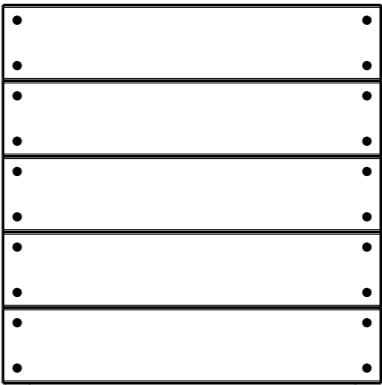

Front view
Scale: 1:20

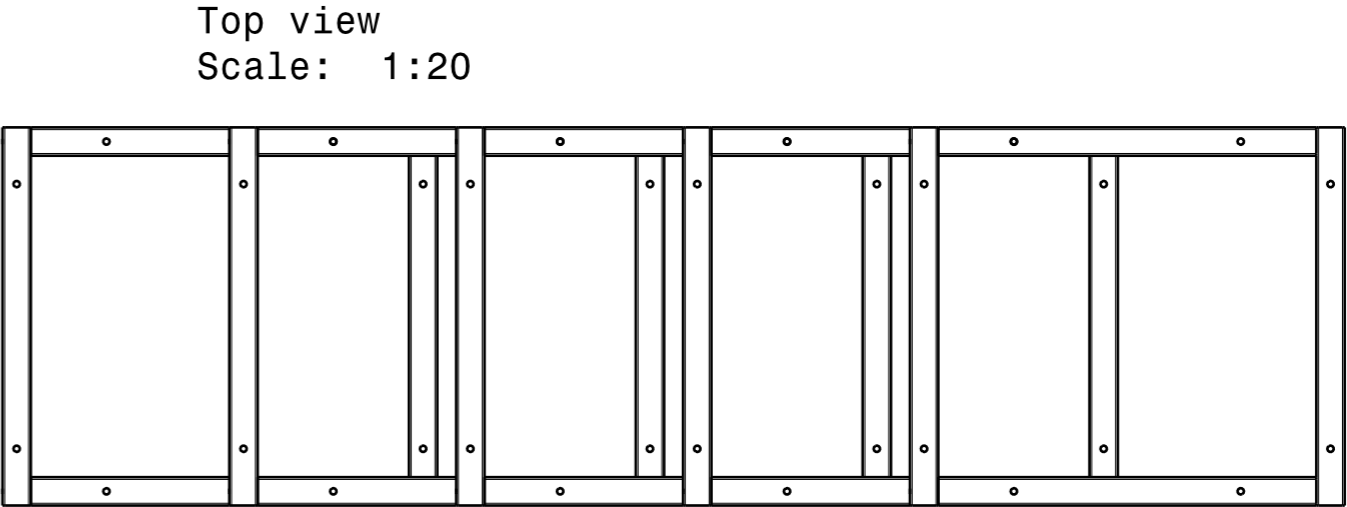

Top view
Scale: 1:20

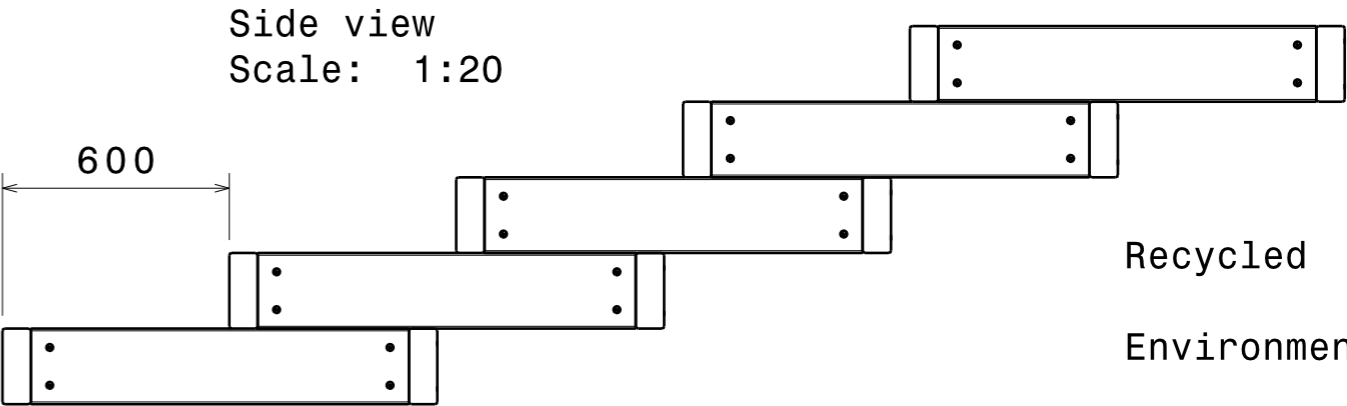

Side view
Scale: 1:20

Recycled
Environmental
Sustainable
Safe

APR manufactures utilising recycled and reclaimed materials
APR products are manufactured to our standard quality control processes
APR manufactures to various lengths

Notice

This drawing was prepared by the staff of Advanced Plastic Recycling and the copyright therein belongs to the company. All rights conferred by the law of copyright and by virtue of international copyright conventions are reserved to the company. Reproduction requires the prior written consent of the company. As the drawing may incorporate confidential information of the company, its disclosure to others requires the company's prior written consent. Any infringement of this copyright may result in legal action.

<div>THIRD ANGLE PROJECTION</div>	<div>Advanced Plastic Recycling, 9/500 Churchill Road KILBURN SA 5084</div> <div> <small>TELEPHONE (08) 8359 4999 FACSIMILE (08) 8359 4988 A.B.N. 75 858 453 725</small> </div>	DESIGNED E.C	SCALE AS SHOWN	MATERIAL A.P.R - W.P.C
		DRAWN E.C	© DATE 1/8/18	SHEET SIZE A3
		CHECKED K.C	APPROVED C.L	A3 SHEET 1 OF 1
		PART NAME Earth Steps Full Assy		PART NO. tba